



Tractors Built for the Best™

FRICUBE
Tractors for Specialists



Welcome Agricube!

Featuring an elegant design and a renewed style, the new Carraro Agricube Series range is presented to the specialised tractor market to meet the many demands of this sector. The new Agricube Series with FPT engines has been designed to blend the Performance, Quality, Trust features with the Versatility of its wide range of applications, from the Vigneto to the open field. Its compact design and high choice of configurations coupled with the comfort offered by the modern ergonomic solutions, make Agricube the perfect tractor for all the various activities typical of specialistic sectors.





F100
AGRICUBE CARRARO

Agricube Frutteto



The range

- › New design and new contents: the Agricube Frutteto (F) series is available with FPT F5C engines in powers of 75 and 88 hp and with FPT NEF100 hp
- › The three different axle widths, the availability of versions with cabin or platform, with tiltable front frame, the wide range of transmissions and the options mix, all make this new series of tractors extremely versatile and well-suited to any needs.
- › The availability of the option with built-in front power take-off and front lifter, Cat. II with lifting capacity of 1,300 kg, further enhances this range's great versatility.
- › The entire range has a mechanical rear lift (basic version) and electronic rear lift with external lift control (optional extra). Both versions guarantee a lifting capacity of 26kN.

Agricube Features

Frutteto



Motor

- › The elegant monobloc hood is easy to open and close and makes access for maintenance simple, blending style and practicality.



Rear tow attachment and lifter

- › A 30kN option is available, thanks to the use of an additional jack.
- › The three-point hitch is available in the following configurations: with fixed, cat. 2 adjustable ball type lower links, category 2/1/N with adjustable quick couplers cat. 2/1/1N.



Remote control electronic lift

- › The electronic lift's remote control, positioned on both rear fenders, facilitates handling of the rear lift.
- › The practical mechanical command remote control is available for the mechanical lift.



Hydraulic system

- › The hydraulic circuit capacity (86 l/min with two pumps in the basic configuration and 101 l/min with the three pump option), guarantees the capacity necessary to meet the highest technical working demands.
- › Use of the lateral SCVs is comfortable and practical thanks to the easy access, with their position guaranteeing excellent visibility from the driving seat.



Cabin

- › Available ventilated/heated (base) or heated/air-conditioned (option)
- › Soundproofed platform suspended on 4 silent blocks
- › The new cabin for special tractors has been designed to provide all the necessary comforts. It is the perfect answer for those who rightly demand to work in a comfortable, yet practical, environment
- › The range includes: cabin width 1,200 mm



Hydraulic system

- › Wide choice of distributor options for the specials range:
 - 2 DE distributors with 4 rear outputs push-pull, flow control on base plate for simultaneous action of distributor and lift
 - 3 DE distributors with 6 rear outputs push-pull, distributor flow control with 2 or 3 pumps
 - 3 DE distributors with 6 rear outputs and 4 side outputs, push-pull, distributor flow control with 2 or 3 pumps.



Driving seat

- › Comfortable, ergonomic and practical, operations are made even easier by the intuitive controls
- › Every single Agricube detail has been designed to simplify use and make driving a more pleasurable experience.



Details

- › Even the smallest detail has been developed to guarantee a compact, clear-cut, dynamic design: fundamental requirements for those working with specialised crops.

Agricube Technical Data

Frutteto

	80 F	90 F	100 F
ENGINE			
Engine manufacture	FPT	FPT	FPT
Engine name	F5C (EURO III A)	F5C (EURO III A)	NEF (EURO III A)
Displacement	3,200 c ³	3,200 c ³	4,500 c ³
Number of cylinders/Configuration	4 turbo	4 turbo intercooler	4 turbo intercooler
Cooling system	Liquid cooled	Liquid cooled	Liquid cooled
Maximum power ISO kW/hp	55/ 74.8	65/ 88.4	74/ 100.6
PTO power ISO kW/hp	46/ 62	55/ 75	63/ 86
Rated engine speed	2,300	2,300	2,200
Maximum torque speed	1,250	1,300	1,250
Maximum torque	310Nm@ 1,250rpm	350Nm@ 1,300rpm	430 Nm@ 1,250rpm
Torque rise	37%	36%	28%
Fuel tank capacity	71 l	71 l	71 l
Fuel tank capacity with Front PTO	50 l	50 l	50 l
Auxiliary tank capacity (option, mandatory with Front PTO)	19 l	19 l	19 l
Exhaust	Horizontal	Horizontal	Horizontal
ELECTRIC SYSTEM			
Battery	100 Ah	100 Ah	100 Ah
Alternator	80 A	80 A	90 A
Engine start	4.2 kW	4.2 kW	4.2 kW
TRANSMISSION			
12+12 12 front 12 rear	Gear Levers: lateral · Gear Box: 4 gear synchro Range: 3 gear range L / M/ Hi collar shift · Reverser: mechanical Minimum tractor speed: 1.5 km/h with rear tyre 14.9R28 Maximum tractor speed: 30 km/h with rear tyre 14.9R28		
24+24 24 front 24 rear	Gear Levers: Lateral · Gear Box: 4 gear synchro Range: 3 gear range L / M/ Hi collar shift · HI-LO: mechanical · Reverser: mechanical Minimum tractor speed: 0.5 km/h with rear tyre 14.9R28 Maximum tractor speed: 40 km/h with rear tyre 14.9R28		
24+24 24 front 24 rear	Gear Levers: Lateral · Gear Box: 4 gear synchro Range: 3 gear range L / M/ Hi collar shift · HI-LO: electrohydraulic Reverser: mechanical · Minimum tractor speed: 0.5 km/h with rear tyre 14.9R28 Maximum tractor speed: 40 km/h with rear tyre 14.9R28		
24+12 24 front 12 rear	Gear Levers: Lateral · Gear Box: 4 gear synchro Range: 3 gear range L / M/ Hi collar shift · HI-LO: electrohydraulic Reverser: electrohydraulic · Minimum tractor speed: 0.5 km/h with rear tyre 14.9R28 Maximum tractor speed: 40 km/h with rear tyre 14.9R28		
MECHANICAL POWER TAKE OFF			
Speed option (dry disc clutch)	540 – 540/ 540 E – 540/ 1,000		
Ground drive PTO	Option		
Speed indicator on dashboard	Base		
ELECTRO HYDRAULIC POWER TAKE OFF			
Speed option (Wet disc clutch)	540/ 540 E – 540/ 1,000		
Ground drive PTO	Base		
Speed indicator on dashboard	Base		

CLUTCH	
Dry independent	11"
BRAKES	
Brake actuation	Mechanical & Hydraulic integrated
Brake configuration	Oil wet disk
REAR DIFFERENTIAL LOCK	
Type	Mechanical
Actuation	Electrohydraulic
FRONT AXLE	
Maximum steering angle	52°
Tilt angle	8°
Flange distance	1,325 mm
4WD actuation	Electrohydraulic
Differential lock	Self-locking
REAR AXLE	
Type	Epiciclic
Ratio	6:1
Flange distance	1,242 mm
HYDRAULIC SYSTEM	
Pumps capacity (lt/min)	With 2 pumps (base): 61.2+24.8 With 3 pumps (option): 41.5+35+24.8
Distributors	1 SE + 1 DE 3 Pos / 1 SE + 1 DE 4 Pos with neutral simple return (4 rear exits), flow control for simultaneous use of distributor and lift
THREE POINT HITCH	
Maximum lift capacity	2,600 kg (base) – 3,000 kg (option)
Lift	Mechanical with position, draft, mix control (base) – Electronic (option)
Three point hitch category	1/1N2 Cat.
Lower links	Fixed, ball-type, Cat. 1 Adjustable, ball-type, Cat. 1/1N Quick coupling, adjustable, Cat. 1/1N
TOW HOOKS	
Pins/Sliding	Category Cuna C (basic), Category Cuna C + D2 (optional)
FRONT WEIGHTS	
Option	4 elements x 30 kg (120 kg) 6 elements x 30 kg (180 kg) 10 elements x 30 kg (300 kg)
DRIVER SEAT OOS	
Platform	Suspended, insonorized, on 4 silent blocks
Frontrops	Front tiltable roll bar
Steering wheel	Fixed (base), Telescopic & tiltable (option)
Seat	Mechanical suspended seat in Pvc (base), Pneumatic suspended seat in Pvc (option)
Mirror	LH Rearview mirror (base) – RH Rearview mirror (option)
Dashboard	Multifunction
Operator's Manual	English/ Italian version (base)
DRIVER SEAT CABIN VERSION	
Cabin	Insonorised, on 4 silent block suspended, ventilated and heated version (base) Insonorised, on 4 silent block suspended, heated and air conditioning version (option)
Steering wheel	Fixed (base), Telescopic & tiltable (option)
Seat	Mechanical suspended seat in textile (base), Pneumatic suspended seat in textile (option)
Mirror	2 external rearview mirrors RH & LH
Dashboard	Multifunction
Operator's Manual	English/ Italian version (base)

Agricube Measurements

Frutteto			
		CAB	OOS
A * (mm)	4 WD	3,991	3,991
A 1 * (mm)	4 WD	4,316	4,316
B max (mm)	4 WD	1,980	1,980
C (mm)	4 WD	2,385	2,533
D * (mm)	4 WD	2,074	2,074
E front (mm)	4 WD	997÷1,625	997÷1,625
E rear (mm)	4 WD	1,10 z 1,646	1,10 z 1,646
F (mm)	4 WD	1,060	1,060
G (mm)	4 WD	295 ant 355 post	295 ant 355 post
H (mm)	4 WD	1,182	1,182
R	4 WD	25° 30'	25° 30'
K	4 WD	24°	24°
Front Tyres	4 WD	320/ 70R20	320/ 70R20
Rear Tyres	4 WD	14.9R28 380/ 85R28	14.9R28 380/ 85R28
Weight** [w/o front weights]	4 WD	2,965 kg	2,730 kg
	4 WD	2,965 kg	2,730 kg
* A, A 1, D with NEF motor: +87 mm** Weight with NEF motor: +70 kg			

Frutteto

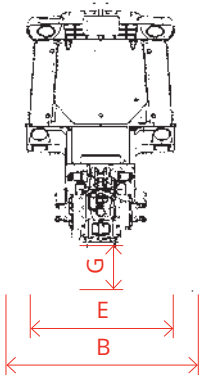
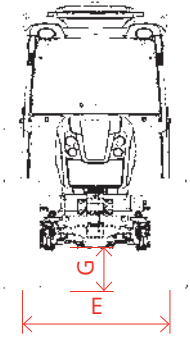
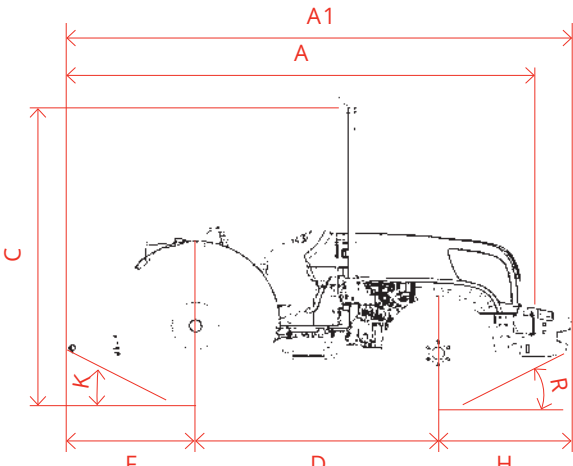
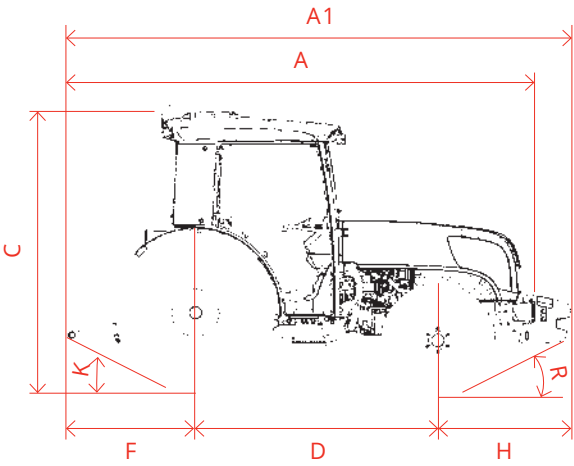



EN

Carraro Tractors - Distributed by Selmac Group
2160 Fifteenth St, Irymple, VIC 3498
Australia
PH (03) 5024 6005

The information in this publication is provided for purely illustrative purposes; the manufacturer reserves the right to modify the models described without prior notice.

Drawings and photographs may refer to optional equipment or special options for other countries. For all other information, contact our sales network.

sales@selmacgroup.com.au



carraroaustralia.com.au